

E-THT1000

PHT OPERATION PROCEDURE

PRODUCT BREAKDOWN

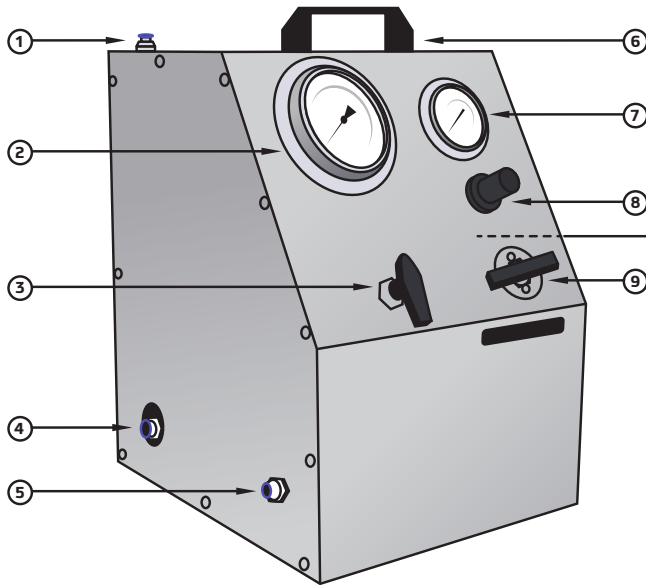

- 1 COMPRESSED AIR INPUT (7 BAR)
- 2 TEST PRESSURE GAUGE
- 3 COMPRESSED AIR SWITCH
- 4 WATER INPUT
- 5 WATER OUTPUT
- 6 LIFTING HANDLE
- 7 AIR PRESSURE GAUGE
- 8 AIR PRESSURE ADJUSTMENT VALVE
- 9 WATER PRESSURE UNLOADING VALVE
- 10 TESTING PORT G 1/2"

OPERATION PROCEDURE

1 Connect Air and Water

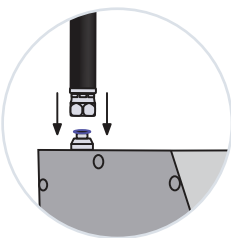

Connect air to
① Compressed Air Input

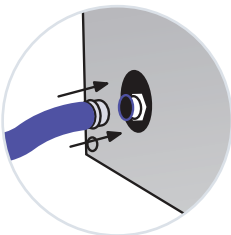

Connect water to
④ Water Input

2 Connect Test Hose

Connect the test hose to the ⑩ Test Port, ensuring the other end of the hose is left unplugged

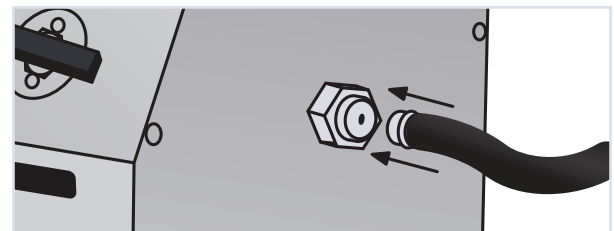

E-THT1000

PHT OPERATION PROCEDURE

3 Turn off Air Pressure

Turn ⑧ Air Pressure Adjustment Valve anticlockwise until it reaches the off position.



4 Turn on Water

Turn on water supply and allow the test hose to fill. Ensure no air bubbles are present.

Plug the end of the test hose once all air is removed.

5 Turn off Water

6 Close Water Pressure Valve

Turn ⑨ Water Pressure Unloading Valve clockwise to turn off.

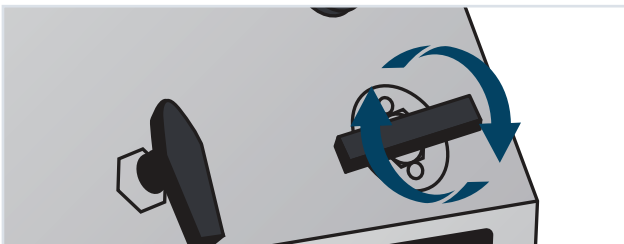

7 Turn on Air

Turn on the ③ Compressed Air Switch.



8 Find Desired Pressure

Slowly turn the ⑧ Air Pressure Adjustment Valve until desired pressure is reached (shown on the ⑦ Test Pressure Gauge).

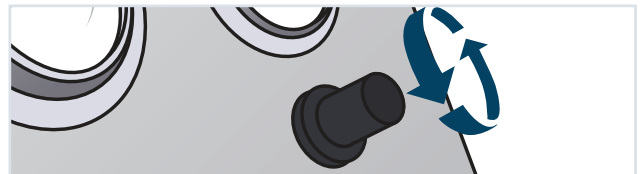

9 Turn off Air

Turn off ③ Compressed Air Switch.

If a pressure drop occurs on ⑦ Test Pressure Gauge, it means there is a leak or a loose connection.

Relieve the pressure (see step 10), tighten connections and repeat steps 4-9.

10 Turning Off

Wind off ⑧ Air Pressure Adjustment Valve and open the ⑨ Water Pressure Valve. Ensure gauges read zero before removing the test hose.